



MILBANK
ENERGY AT WORK



363616-CT3R-WB

Catalog Number	363616-CT3R-WB
Marketing Product Description	36x16x36 Hinge Cover Type 3R UL Listed Steel No Knockouts ANSI 61 Gray Double Doors Wood Back Board Installed Handle On Right Padlocking 3 Point Handle Lift Off Hinges
UPC	784572258976
Length (IN)	16
Width (IN)	36
Height (IN)	36
Weight (LB)	130
Brand Name	Milbank
Type	Hinge Cover
Application	Current Transformer Enclosure
Standard	UL Listed
Material	G90 Galvanized Steel with Powder Coat Finish
Size	16L x 36W x 36H
Color	ANSI 61 Gray
Cable Entry	No Knockouts
Mounting	Pad Mount or Wall Mount
NEMA Rating	Type 3R
Door or Cover	Double Door
Back Panel	Wood Back Panel Included

Please consult serving utility for their requirements prior to ordering or installing, as specifications and approvals vary by utility and may require local electrical inspector approval. All installations must be installed by a licensed electrician and must comply with all national and local codes, laws and regulations. Milbank reserves the right to make changes in specifications and features shown without notice or obligation.

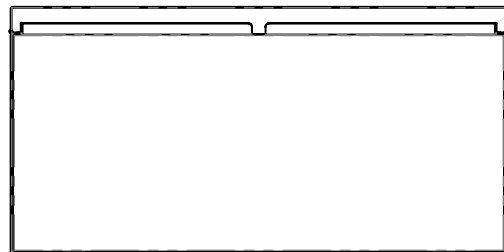
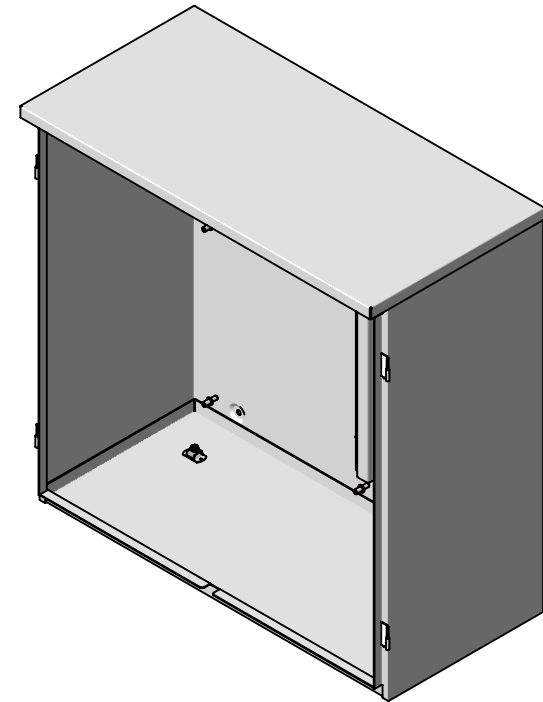
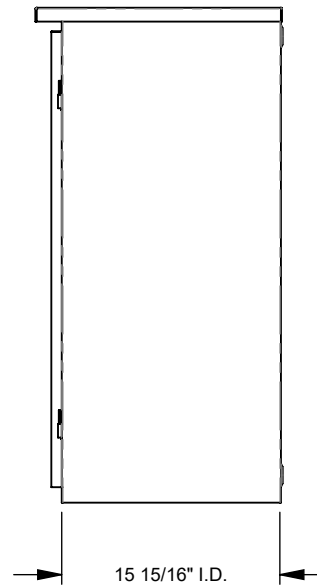
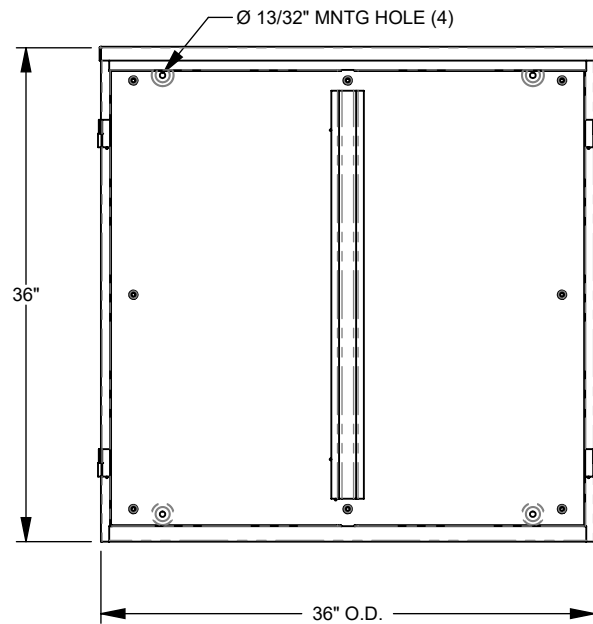

MILBANK
ENERGY AT WORK

Version:

1

**All dimensions are +/- 1/16".
Drawing views are not to scale.**

Please consult serving utility for their requirements prior to ordering or installing, as specifications and approvals vary by utility, and may require local electrical inspector approval. All installations must be installed by a licensed electrician and must comply with all national and local codes, laws and regulations. Milbank reserves the right to make changes in specifications and features shown without notice or obligation.