



**MILBANK**  
ENERGY AT WORK

## 363611-CT3R-SP1



Catalog Number	363611-CT3R-SP1
Marketing Product Description	36x11x36 Hinge Cover Type 3R UL Listed Steel No Knockouts ANSI Gray Continuous Hinge Slotted Quarter Turn Latch Padlocking Wing Handle Weld Studs In Back Door Stiffener Ground Stud
UPC	784572543140
Length (IN)	11
Width (IN)	36
Height (IN)	36
Weight (LB)	118
Brand Name	Milbank
Type	Hinge Cover
Special Features	Drip Shield; Stiffeners on Door; Continuous Hinge Cover; Ground Stud
Application	Current Transformer Enclosure
Standard	UL Listed
Material	G90 Galvanized Steel with Powder Coat Finish
Size	11L x 36W x 36H
Color	ANSI 61 Gray
Cable Entry	No Knockouts

Mounting	Mounting Studs and External Mounting Feet
NEMA Rating	Type 3R
Door or Cover	Single Door
Back Panel	Mounting Emboss on Enclosure Back

Please consult serving utility for their requirements prior to ordering or installing, as specifications and approvals vary by utility and may require local electrical inspector approval. All installations must be installed by a licensed electrician and must comply with all national and local codes, laws and regulations. Milbank reserves the right to make changes in specifications and features shown without notice or obligation.

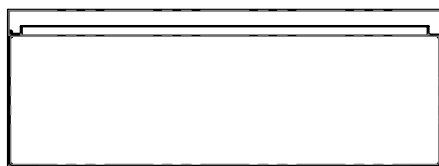
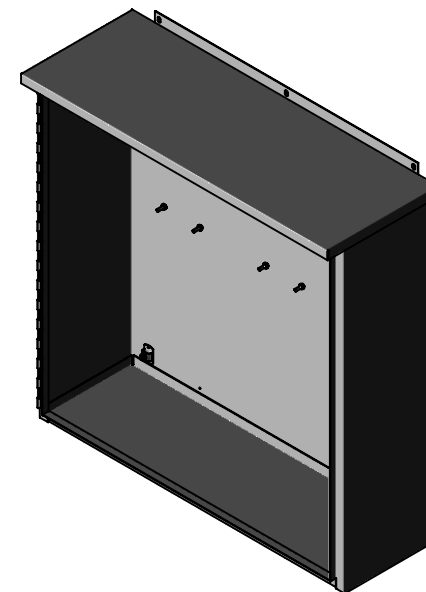
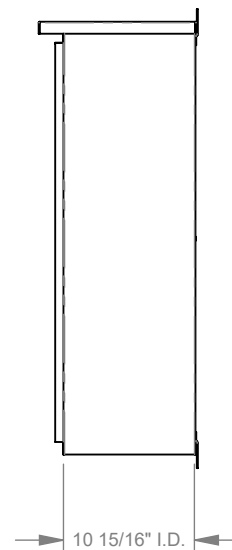
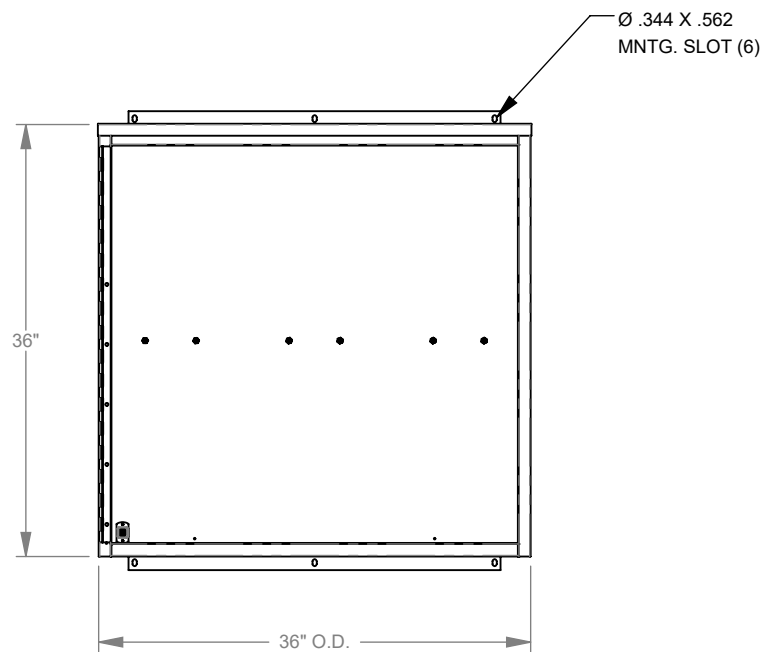

**MILBANK**  
ENERGY AT WORK

Version:

**1**

**All dimensions are +/- 1/16".  
Drawing views are not to scale.**

Please consult serving utility for their requirements prior to ordering or installing, as specifications and approvals vary by utility, and may require local electrical inspector approval. All installations must be installed by a licensed electrician and must comply with all national and local codes, laws and regulations. Milbank reserves the right to make changes in specifications and features shown without notice or obligation.