



**MILBANK**  
ENERGY AT WORK



## 484812-CT3R-SP-WB

Catalog Number	484812-CT3R-SP-WB	Door or Cover	Double Door
Marketing Product Description	48x12x44 Hinge Cover Type 3R Steel No Knockouts ANSI 61 Gray Continuous Hinge Double Doors Handle On Left Wood Back Board Installed	Back Panel	Wood Back Panel Included
UPC	784572630109		
Length (IN)	12		
Width (IN)	48		
Height (IN)	48		
Weight (LB)	200		
Brand Name	Milbank		
Type	Hinge Cover		
Special Features	Mounting Emboss on Enclosure Back; Door Stiffeners; Body Stiffeners; Continuous Hinge Cover		
Application	Current Transformer Enclosure		
Standard	UL Listed		
Material	G90 Galvanized Steel with Powder Coat Finish		
Size	12L x 48W x 48H		
Color	ANSI 61 Gray		
Cable Entry	No Knockouts		
Mounting	Pad Mount or Wall Mount		
NEMA Rating	Type 3R		

Please consult serving utility for their requirements prior to ordering or installing, as specifications and approvals vary by utility and may require local electrical inspector approval. All installations must be installed by a licensed electrician and must comply with all national and local codes, laws and regulations. Milbank reserves the right to make changes in specifications and features shown without notice or obligation.

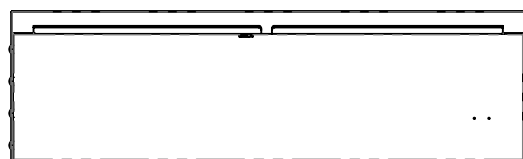
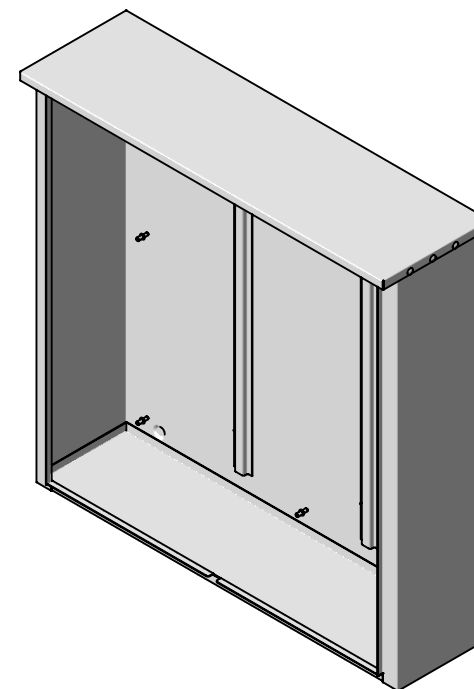
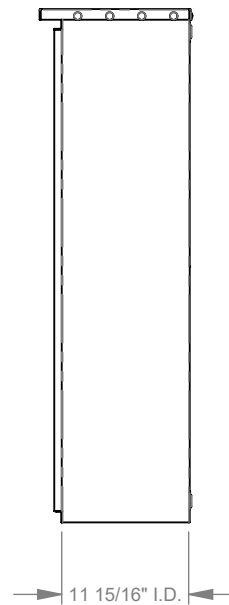
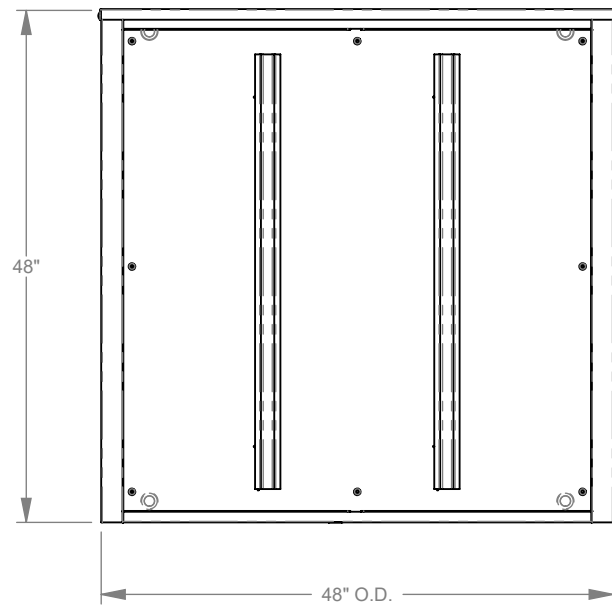

**MILBANK**  
ENERGY AT WORK

Version:

**1**

**All dimensions are +/- 1/16".  
Drawing views are not to scale.**

Please consult serving utility for their requirements prior to ordering or installing, as specifications and approvals vary by utility, and may require local electrical inspector approval. All installations must be installed by a licensed electrician and must comply with all national and local codes, laws and regulations. Milbank reserves the right to make changes in specifications and features shown without notice or obligation.