



MILBANK
ENERGY AT WORK

U1252-X-KK-K3-PEP



Catalog Number	U1252-X-KK-K3-PEP
Marketing Product Description	4 Terminal Ringless Large Closing Plate Horn Bypass 2 Position Single Connector 4-600kcmil Pepco
UPC	784572726338
Length (IN)	5.125
Width (IN)	26.5
Height (IN)	14
Brand Name	Milbank
Type	Ringless Meter Socket
Application	Meter Socket
Standard	UL Listed; Type 3R
Voltage Rating	300 Volts Alternating Current
Amperage Rating	400 Continuous Ampere
Phase	1 Phase
Frequency Rating	60 Hertz
Size	5.13L x 26.5W x 14H
Number Of Cutouts	0
Cutout Size	No Main Breaker
Cable Entry	Overhead or Underground
Terminal	3/8 Inch Stud
Insulation	Glass Polyester
Mounting	Surface Mount

Enclosure	G90 Galvanized Steel with Powder Coat Finish
-----------	--

Jaw Quantity	4 Terminal
--------------	------------

Bypass Type	Horn Bypass
-------------	-------------

Number of Meter Positions	2 Positions
---------------------------	-------------

Equipment Ground	Ground Lug
------------------	------------

Hub Opening	Large Closing Plate
-------------	---------------------

Number Of Receptacles	0
-----------------------	---

Please consult serving utility for their requirements prior to ordering or installing, as specifications and approvals vary by utility and may require local electrical inspector approval. All installations must be installed by a licensed electrician and must comply with all national and local codes, laws and regulations. Milbank reserves the right to make changes in specifications and features shown without notice or obligation.

FEATURE TABLE		
ITEM	QTY	DESCRIPTION
A	4	STD. MNTG. EMBOSS
B	1	¼ SOLID K.O.
C	2	⅞ SOLID K.O.
D	1	½, ¾, 1 CONC. K.O.
E	6	1¼, 1½, 2, 2½ CONC. K.O.
F	1	2, 2½, 3 CONC. K.O.

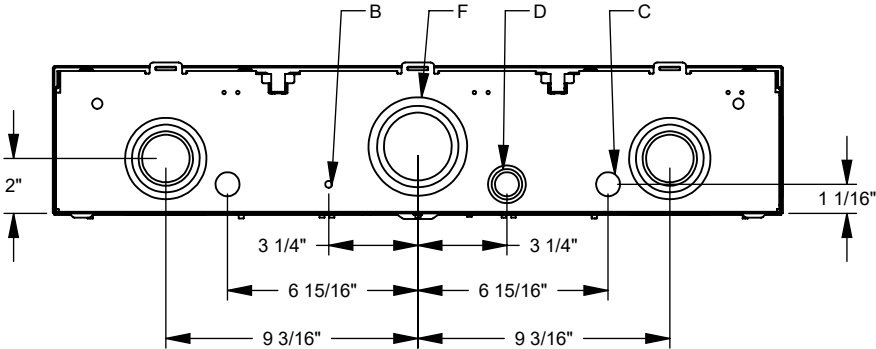
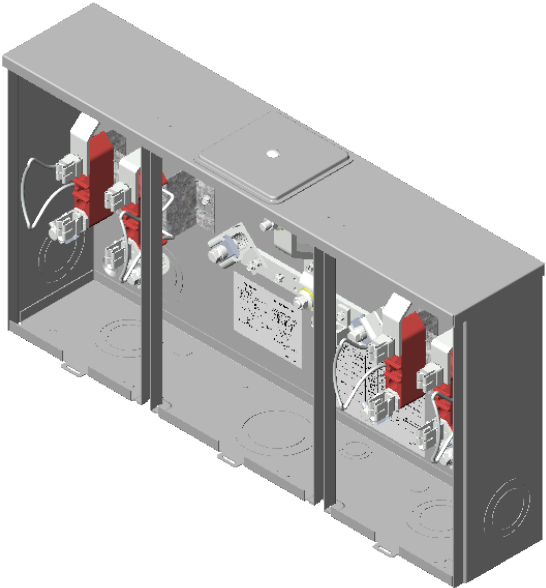
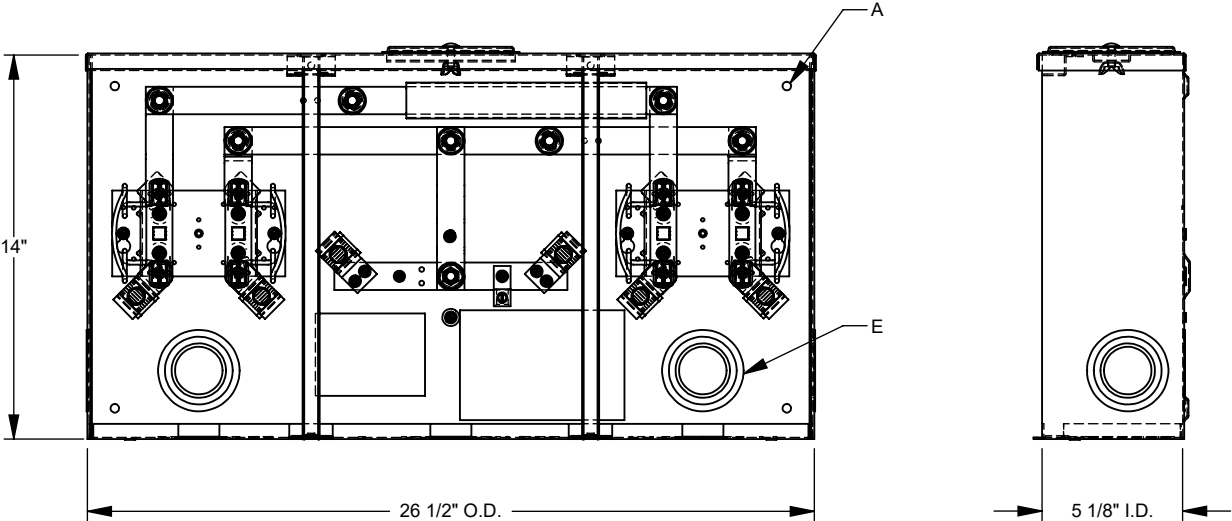

Version:

1

**All dimensions are +/- 1/16".
Drawing views are not to scale.**

Please consult serving utility for their requirements prior to ordering or installing, as specifications and approvals vary by utility, and may require local electrical inspector approval. All installations must be installed by a licensed electrician and must comply with all national and local codes, laws and regulations. Milbank reserves the right to make changes in specifications and features shown without notice or obligation.